

3 SYGNALIZATORY ŚWIETLNO-DŹWIĘKOWE

3.1 SERIA SLEM

3.1.1 SERIA SLEM – ŹRÓDŁO ŚWIATŁA – ŻARÓWKI

V 12-24-48-110-240 (±10%)	==	~ 50/60 Hz	IP 43	□	Hz(==) 650 ± 50
Praca ∞	Hz(==) 650±50	Hz(~) 300÷7000	🎵 —	°C -30 +50	
Błysk/min. 110±20				PC	

Wersja z żarówką

Światło błyskające - dźwięk ciągły

 SLEM L
SLEML

 BA 15d 5W LR BA 15d 5W	V ==	12 ÷ 24 ÷ 48		
		mA	480	250
	Cd (p)	4	3	3
 BA 15d 10W LR BA 15d 10W	mA	880	470	250
	Cd (p)	6	5	5
	dB(A)	96	96	96
Hz 650 ± 50				

 BA 15d 5W LR BA 15d 5W	V ~	24 ÷ 48 ÷ 110 ÷ 240			
		mA	350	210	100
	Cd (p)	4	3	3	3
 BA 15d 10W LR BA 15d 10W	mA	600	330	150	80
	Cd (p)	5	5	4	4
	dB(A)	92	92	92	92
Hz 300 ÷ 7000					

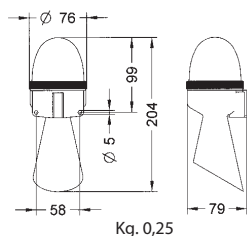

SLEML12D2	●	40322	SLEML24A2	●	40642	SLEML48A2	●	40372	SLEML240A2	●	40702
SLEML12D3	●	40323	SLEML24A3	●	40353	SLEML48A3	●	40373	SLEML240A3	●	40423
SLEML12D4	●	40324	SLEML24A4	●	40354	SLEML48A4	●	40374	SLEML240A4	●	40424
SLEML24D2	●	40342	SLEML48D2	●	40362	SLEML110A2	●	40392			
SLEML24D3	●	40343	SLEML48D3	●	40363	SLEML110A3	●	40393			
SLEML24D4	●	40344	SLEML48D4	●	40364	SLEML110A4	●	40394			

Światło ciągłe - dźwięk ciągły

 SLEM F
SLEMF

 BA 15d 5W LR BA 15d 5W	V ==	12	24	48	110	240
		mA	480	250	130	55
	Cd (p)	4	3	3	2.5	2.5
 BA 15d 10W LR BA 15d 10W	mA	880	470	250	115	60
	Cd (p)	6	5	5	4	4
	dB(A)	96	96	96	96	96
Hz 650 ± 50						

 BA 15d 5W LR BA 15d 5W	V ~	12	24	48	110	240
		mA	550	350	210	100
	Cd (p)	4	3	3	2.5	2.5
 BA 15d 10W LR BA 15d 10W	mA	1	0.6	0.33	0.15	0.08
	Cd (p)	6	5	5	4	4
	dB(A)	92	92	92	92	92
Hz 300 ÷ 7000						

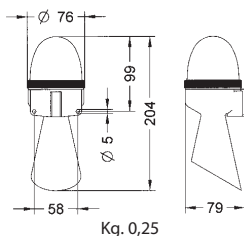

SLEMF12D2	●	40622	SLEMF24A1	●	40711	SLEMF48A4	●	40674	SLEMF240D4	●	40414
SLEMF12D3	●	40623	SLEMF24A2	●	40712	SLEMF110D2	●	40682	SLEMF240A1	●	40721
SLEMF12D4	●	40624	SLEMF24A3	●	40713	SLEMF110D3	●	40683	SLEMF240A2	●	40422
SLEMF12A2	●	40632	SLEMF24A4	●	40714	SLEMF110D4	●	40684	SLEMF240A3	●	40703
SLEMF12A3	●	40633	SLEMF48D2	●	40662	SLEMF110A2	●	40692	SLEMF240A4	●	40704
SLEMF12A4	●	40634	SLEMF48D3	●	40663	SLEMF110A3	●	40693	SLEMF240A5	●	40705
SLEMF24D2	●	40352	SLEMF48D4	●	40664	SLEMF110A4	●	40694	SLEMF240A6	○	40706
SLEMF24D3	●	40643	SLEMF48A2	●	40672	SLEMF240D2	●	40412			
SLEMF24D4	●	40644	SLEMF48A3	●	40673	SLEMF240D3	●	40413			

3.1.2 SERIA SLEM - ŹRÓDŁO ŚWIATŁA - DIODA LED SMD

$V \begin{matrix} 12 \\ \sim \\ 24 \end{matrix} - \begin{matrix} 24 \\ \sim \\ 110 \end{matrix} - 240 \sim$
 \equiv
 $\sim 50/60 \text{ Hz}$
 \square
 $\text{Praca } \infty$

$^{\circ}\text{C} -30 +50$
 PC
 $\text{Błysk/min. } 0/1\text{F}:120 \pm 10/ 2\text{F}: 2 \times 90 \pm 10/3\text{F}:3 \times 140 \pm 10$

Wersja z diodami LED SMD

- 4 tryby pracy: światło ciągłe, 1, 2 lub 3 flesze wybierane za pomocą przełączników oraz dźwięk ciągły



$V \text{ ---}$	12	24
mA	75	65
dB(A)	96	96
Hz 650 ± 50		

$V \sim$	12	24	110	240
mA	165	200	75	50
dB(A)	92	92	92	92
Hz 300 ÷ 7000				

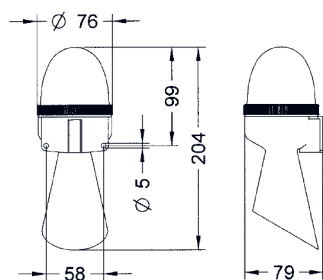

SLEMMULTISMD12D1	● 38821	SLEMMULTISMD24D1	● 38841	SLEMMULTISMD110A1	● 38861
SLEMMULTISMD12D2	● 38822	SLEMMULTISMD24D2	● 38842	SLEMMULTISMD110A2	● 38862
SLEMMULTISMD12D3	● 38823	SLEMMULTISMD24D3	● 38843	SLEMMULTISMD110A3	● 38863
SLEMMULTISMD12D4	● 38824	SLEMMULTISMD24D4	● 38844	SLEMMULTISMD110A4	● 38864
SLEMMULTISMD12D5	● 38825	SLEMMULTISMD24D5	● 38845	SLEMMULTISMD110A5	● 38865
SLEMMULTISMD12D6	○ 3882B	SLEMMULTISMD24D6	○ 38846	SLEMMULTISMD110A6	○ 38866
SLEMMULTISMD12A1	● 38831	SLEMMULTISMD24A1	● 38851	SLEMMULTISMD240A1	● 38871
SLEMMULTISMD12A2	● 38832	SLEMMULTISMD24A2	● 38852	SLEMMULTISMD240A2	● 38872
SLEMMULTISMD12A3	● 38833	SLEMMULTISMD24A3	● 38853	SLEMMULTISMD240A3	● 38873
SLEMMULTISMD12A4	● 38834	SLEMMULTISMD24A4	● 38854	SLEMMULTISMD240A4	● 38874
SLEMMULTISMD12A5	● 38835	SLEMMULTISMD24A5	● 38855	SLEMMULTISMD240A5	● 38875
SLEMMULTISMD12A6	○ 38836	SLEMMULTISMD24A6	○ 38856	SLEMMULTISMD240A6	○ 38876

3.1.3 SERIA SLEM - ŹRÓDŁO ŚWIATŁA - ŻARÓWKA KSENONOWA

$V 24-110-240 (\pm 10\%)$
 \equiv
 $\sim 50/60 \text{ Hz}$
 $J 2$
 $2 F$
 $\text{Błysk/min. } 65 \pm 10$

$\text{IP } 43$
 $\text{Praca } \infty$
 \square
 $\text{Hz } (\equiv) 650 \pm 50$
 $\text{Hz } (\sim) 300 \div 7000$
 $\text{Praca } \infty$
 $^{\circ}\text{C} -30 +40$

PC

Ksenonowe światło błyskające - dźwięk ciągły



SLEM X
SLEM X

	$V \text{ ---}$	24
	mA	350
	Cd (p)	200 / 100
	dB(A)1m	96
Hz 650 ± 50		

BA 15d 10W
LR BA 15d 10W

$V \sim$	24	110	240
mA	500	80	70
Cd (p)	200 / 100	200 / 100	200 / 100
dB(A)1m	92	92	92
Hz 300 ÷ 7000			

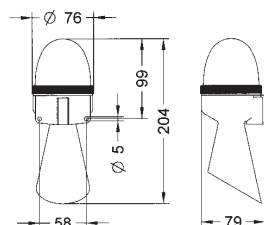

SLEM X24D2	● 40432	SLEM X110A2	● 40452
SLEM X24D3	● 40433	SLEM X110A3	● 40453
SLEM X24D4	● 40434	SLEM X110A4	● 40454
SLEM X24A2	● 40442	SLEM X240A2	● 40462
SLEM X24A3	● 40443	SLEM X240A3	● 40463
SLEM X24A4	● 40444	SLEM X240A4	● 40464

Kg. 0,25