

3.4 SERIA LD 125 MICROLAMP

V 12-24-48-110-210(±10%)		50/60 Hz	Błysk/min.0-130 ±20	IP 30	
	°C -30 +50	Praca ∞			PC

Wersja z żarówką
Światło błyskające (lub ciągłe), dźwięk przerywany (lub ciągły), źródło światła żarówka

**MICROLAMP A FCL
MLAFCL**

	V	12	24	48	-	-
	V				110	240
	mA	430	215	105	45	20
	Cd (p)	25	18	8	3	2
	dB(A)1m	75	75	75	75	75
	Hz 2700		F/M 110		F/M 0	

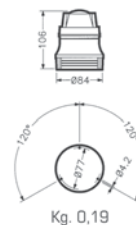
 Ba 15d 5W
LR Ba 15d 5W

Kg. 0,19

MLAFCL12DA1 ● 79721	MLAFCL24DA3 ● 79733	MLAFCL48DA5 ○ 79745	MLAFCL240A1 ● 79771
MLAFCL12DA2 ● 79722	MLAFCL24DA4 ● 79734	MLAFCL48DA6 ○ 79746	MLAFCL240A2 ● 79772
MLAFCL12DA3 ● 79723	MLAFCL24DA5 ● 79735	MLAFCL110A1 ● 79751	MLAFCL240A3 ● 79773
MLAFCL12DA4 ● 79724	MLAFCL24DA6 ○ 79736	MLAFCL110A2 ● 79752	MLAFCL240A4 ● 79774
MLAFCL12DA5 ● 79725	MLAFCL48DA1 ● 79741	MLAFCL110A3 ● 79753	MLAFCL240A5 ● 79775
MLAFCL12DA6 ○ 79726	MLAFCL48DA2 ● 79742	MLAFCL110A4 ● 79754	MLAFCL240A6 ○ 79776
MLAFCL24DA1 ● 79731	MLAFCL48DA3 ● 79743	MLAFCL110A5 ● 79755	
MLAFCL24DA2 ● 79732	MLAFCL48DA4 ● 79744	MLAFCL110A6 ○ 79756	

Wersja z diodami LED SMD

V 12/24 -48 -90/240		50/60 Hz	Błysk/min.0-3 x 140 ±10	IP 54	°C -30 +50
IP30(ML A)	Praca ∞		(ML A)		PC

Światło ciągłe i dźwięk ciągły lub światło migające (3 flesze) i dźwięk przerywany

V	12/24	48	90/240
mA	180	115	40
dB(A)1m	72	72	72



MLNAFLSMD1224DA1 ● 38631	MLNAFLSMD48DA1 ● 38641	MLNAFLSMD90240A1 ● 38651
MLNAFLSMD1224DA2 ● 38632	MLNAFLSMD48DA2 ● 38642	MLNAFLSMD90240A2 ● 38652
MLNAFLSMD1224DA3 ● 38633	MLNAFLSMD48DA3 ● 38643	MLNAFLSMD90240A3 ● 38653
MLNAFLSMD1224DA4 ● 38634	MLNAFLSMD48DA4 ● 38644	MLNAFLSMD90240A4 ● 38654
MLNAFLSMD1224DA5 ● 38635	MLNAFLSMD48DA5 ● 38645	MLNAFLSMD90240A5 ● 38655
MLNAFLSMD1224DA6 ○ 38636	MLNAFLSMD48DA6 ○ 38646	MLNAFLSMD90240A6 ○ 38656

4 SYGNALIZACJA ŚWIETLNA DO STREF ZAGROŻONYCH WYBUCEM

4.1 SERIA EX 050 OVO

V 12-24-48-110-240(±10%)		~ 50/60 Hz	Błysk/min. 110 ±20	IP 66
°C -25 +50	Praca ∞			PC
			M25X1.5 *	



II 2 GD Ex de IIC Ex tD A21

Lampa do strefy zagrożonej wybuchem, światło migające (źródło światła – żarówka)



EX 050 OVO L

		CESI 05 ATEX 043				T6
	V $\ddot{\sim}$	12	24	48	-	-
	V \sim	-	24	48	110	240
	mA	430	210	100	35	22
	Cd (p)	3.6	2.7	2.7	2.3	2.3

EX050OVOL12D1	● 95101	EX050OVOL48D4	● 95134
EX050OVOL12D2	● 95102	EX050OVOL48D5	● 95135
EX050OVOL12D3	● 95103	EX050OVOL48D6	● 95136
EX050OVOL12D4	● 95104	EX050OVOL48A1	● 95141
EX050OVOL12D5	● 95105	EX050OVOL48A2	● 95142
EX050OVOL12D6	○ 95106	EX050OVOL48A3	● 95143
EX050OVOL24D1	● 95111	EX050OVOL48A4	● 95144
EX050OVOL24D2	● 95112	EX050OVOL48A5	● 95145
EX050OVOL24D3	● 95113	EX050OVOL48A6	○ 95146
EX050OVOL24D4	● 95114	EX050OVOL110A1	● 95151
EX050OVOL24D5	● 95115	EX050OVOL110A2	● 95152
EX050OVOL24D6	○ 95116	EX050OVOL110A3	● 95153
EX050OVOL24A1	● 95121	EX050OVOL110A4	● 95154
EX050OVOL24A2	● 95122	EX050OVOL110A5	● 95155
EX050OVOL24A3	● 95123	EX050OVOL110A6	○ 95156
EX050OVOL24A4	● 95124	EX050OVOL240A1	● 95161
EX050OVOL24A5	● 95125	EX050OVOL240A2	● 95162
EX050OVOL24A6	○ 95126	EX050OVOL240A3	● 95163
EX050OVOL48D1	● 95131	EX050OVOL240A4	● 95164
EX050OVOL48D2	● 95132	EX050OVOL240A5	● 95165
EX050OVOL48D3	● 95133	EX050OVOL240A6	○ 95166

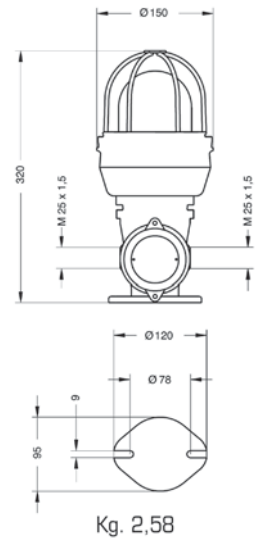

V 24-48-110-240(±10%)		~ 50/60 Hz	Błysk/min. 150 ±20	IP 66
°C -25 +50	Praca ∞			PC
			M25X1.5 *	



II 2 GD Ex de IIC Ex tD A21

Lampa do strefy zagrożonej wybuchem, światło migające (źródło światła – dioda LED)



EX 050 LD 125 OVO

		CESI 05 ATEX 043				T6
	V $\ddot{\sim}$	24	48	-	-	
	V \sim	-	-	110	240	
	mA $\ddot{\sim}$	90	65	20	20	
	mA \sim	80	65	20	20	

EX050LD125OVO24DA1	● 95221	EX050LD125OVO110A1	● 95241
EX050LD125OVO24DA2	● 95222	EX050LD125OVO110A2	● 95242
EX050LD125OVO24DA3	● 95223	EX050LD125OVO110A3	● 95243
EX050LD125OVO24DA4	● 95224	EX050LD125OVO110A4	● 95244
EX050LD125OVO24DA5	● 95225	EX050LD125OVO110A5	● 95245
EX050LD125OVO24DA6	○ 95226	EX050LD125OVO110A6	○ 95246
EX050LD125OVO48DA1	● 95231	EX050LD125OVO240A1	● 95251
EX050LD125OVO48DA2	● 95232	EX050LD125OVO240A2	● 95252
EX050LD125OVO48DA3	● 95233	EX050LD125OVO240A3	● 95253
EX050LD125OVO48DA4	● 95234	EX050LD125OVO240A4	● 95254
EX050LD125OVO48DA5	● 95235	EX050LD125OVO240A5	● 95255
EX050LD125OVO48DA6	○ 95236	EX050LD125OVO240A6	○ 95256

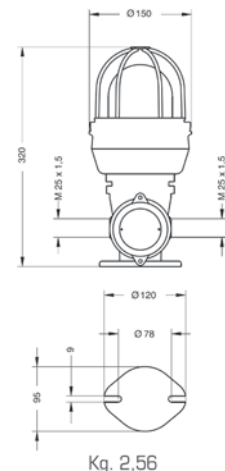

4.2 SERIA EX 070 MAFL

V 12-24-48-110-240(±10%)		 50/60 Hz	Błysk/min. 110 ±20	IP 66
°C -25 +50	Praca ∞	 1 2 3 4 5 6	PC	 M25X1.5 *

II 2 GD Ex de IIC Ex tD A21 Lampa do stref zagrożonych wybuchem, światło migające, (źródło światła żarówka)



EX 070 MAFL L

CESI 05 ATEX 043 T6

	V $\ddot{\sim}$	12	24	48	-	-
	V \sim	-	24	48	110	240
	A	2.2	1.1	0.52	0.22	0.10
	Cd (p)	121	126	126	18	27

Ba 15d 25W
LR Ba 15d 25W

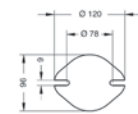
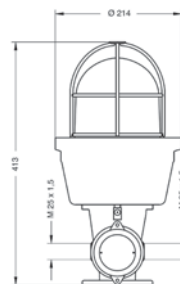
EX070MAFL12D1	●	95481	EX070MAFL24A3	●	95503	EX070MAFL48A5	●	95525
EX070MAFL12D2	●	95482	EX070MAFL24A4	●	95504	EX070MAFL48A6	○	95526
EX070MAFL12D3	●	95483	EX070MAFL24A5	●	95505	EX070MAFL110A1	●	95531
EX070MAFL12D4	●	95484	EX070MAFL24A6	○	95506	EX070MAFL110A2	●	95532
EX070MAFL12D5	●	95485	EX070MAFL48D1	●	95511	EX070MAFL110A3	●	95533
EX070MAFL12D6	○	95486	EX070MAFL48D2	●	95512	EX070MAFL110A4	●	95534
EX070MAFL24D1	●	95491	EX070MAFL48D3	●	95513	EX070MAFL110A5	●	95535
EX070MAFL24D2	●	95492	EX070MAFL48D4	●	95514	EX070MAFL110A6	○	95536
EX070MAFL24D3	●	95493	EX070MAFL48D5	●	95515	EX070MAFL240A1	●	95541
EX070MAFL24D4	●	95494	EX070MAFL48D6	○	95516	EX070MAFL240A2	●	95542
EX070MAFL24D5	●	95495	EX070MAFL48A1	●	95521	EX070MAFL240A3	●	95543
EX070MAFL24D6	○	95496	EX070MAFL48A2	●	95522	EX070MAFL240A4	●	95544
EX070MAFL24A1	●	95501	EX070MAFL48A3	●	95523	EX070MAFL240A5	●	95545
EX070MAFL24A2	●	95502	EX070MAFL48A4	●	95524	EX070MAFL240A6	○	95546



Kg. 4,68

V 24-48-110-240(±10%)		 50/60 Hz	Błysk/min. 150 ±20	IP 66
°C -25 +50	Praca ∞	 1 2 3 4 5 6	PC	 M25X1.5 *



II 2 GD Ex de IIC Ex tD A21
Lampa do strefy zagrożonej wybuchem, światło migające (źródło światła - dioda LED)

EX 070 LD 455 MX

CESI 05 ATEX 043 T6

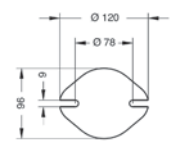
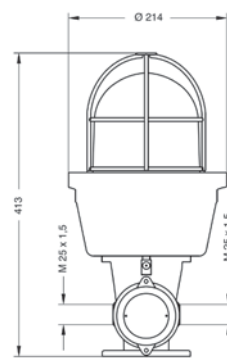

V $\ddot{\sim}$	24	48	-	-
V \sim			110	240
mA $\ddot{\sim}$	180	170	40	40
mA \sim	170	170	40	40

EX070LD455MX24DA1	●	95601	EX070LD455MX110A1	●	95621
EX070LD455MX24DA2	●	95602	EX070LD455MX110A2	●	95622
EX070LD455MX24DA3	●	95603	EX070LD455MX110A3	●	95623
EX070LD455MX24DA4	●	95604	EX070LD455MX110A4	●	95624
EX070LD455MX24DA5	●	95605	EX070LD455MX110A5	●	95625
EX070LD455MX24DA6	○	95606	EX070LD455MX110A6	○	95626
EX070LD455MX48DA1	●	95611	EX070LD455MX240A1	●	95631
EX070LD455MX48DA2	●	95612	EX070LD455MX240A2	●	95632
EX070LD455MX48DA3	●	95613	EX070LD455MX240A3	●	95633
EX070LD455MX48DA4	●	95614	EX070LD455MX240A4	●	95634
EX070LD455MX48DA5	●	95615	EX070LD455MX240A5	●	95635
EX070LD455MX48DA6	○	95616	EX070LD455MX240A6	○	95636



Kg. 4,73

4.3 SERIA EX 070 LF 100

V 240(±10%)			 50/60 Hz
IP 66	°C -25 +50	Praca ∞	 M25X1.5 *



II 2 GD Ex de IIC Ex tD A21

Lampa oświetleniowa do stref zagrożonych wybuchem



EX 070 LF 100

CESI 05 ATEX 043 T4

	$V \sim$	240
	A	0.45
	Cd (p)	90

EX070LF100240A6 ○ 95686



4.4 SERIA EX LD SA

V 240(±10%)	 50/60 Hz	IP 66
°C -25 +50	Praca ∞	 M25X1.5 *



II 2 GD Ex de IIC Ex tD A21

Lampa do stref zagrożonych wybuchem, (źródło światła diody LED)



EX 050 LD SO 545

CESI 05 ATEX 043 T6

$V \sim$	240
mA	25
Cd (p)	22 (max) 7 (min)
W	6

EX050LDSO545240A3 ● 96653

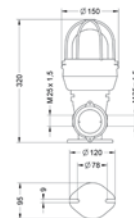

EX 070 LD SO 905

CESI 05 ATEX 043 T6

$V \sim$	240
mA	22
Cd (p)	>10
W	5

EX080LDSO1505240A3 ● 96673

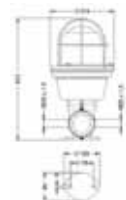

Zgodnie z ICAO ANNEX CHAPTER 6- niska intensywność typu A

EX 080 LD SO 2105



CESI 05 ATEX 043 T6

$V \sim$	240
mA	78
Cd (p)	>32
W	15

EX080LDSO2105240A3 ● 97033

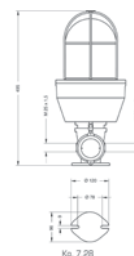

Zgodnie z ICAO ANNEX CHAPTER 6- niska intensywność typu A



EX 050 LD SA 835



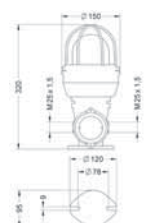

CESI 05 ATEX 043 T6

$V \sim$	240
mA	40
Cd (p)	22 (max) 7 (min)
W	9

EX050LDSA835240A3 ● 96643



5 SYGNALIZACJA DŹWIĘKOWA DO STREF ZAGROŻONYCH WYBUCEM

V 12-24-110-240 (±10%)		 50/60 Hz	On:1 min Off:10 min
IP ⁶⁵ ₆₆		°C -50 +50	 Ø 1/2" NPT Ø 3/4" ISO 7/1**

II 2 GD Ex de IIC Ex tD A21
Syreny przemysłowe do stref zagrożonych wybuchem
IP₆₆

ETS30/100DB

	ISSeP 08	ATEX 004 X	T6	
V 	12	24	100	240-
A	3	1.6	0.45	0.3
dB(A)1m	100	100	100	100
Hz	1500	1500	1600	1600

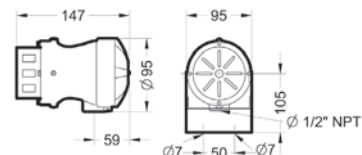

Kg. 1,45

ETS30100DB12DA	62234	ETS30100DB110DA	62236
ETS30100DB24DA	62235	ETS30100DB240DA	62237

ETS60/109DB**



	INERIS 02	ATEX 0001	T6	
V 	12	24	100	240-
A	15	8.5	2	1
dB(A)1m	109	109	109	109
Hz	1150	1250	1300	1300

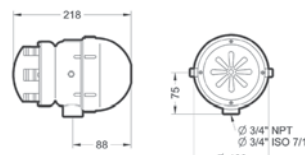

Kg. 3,20

ETS60109DB12DA	62233	ETS60109DB110DA	62232
ETS60109DB24DA	62231	ETS60109DB240DA	62230

ETS60/114DB**





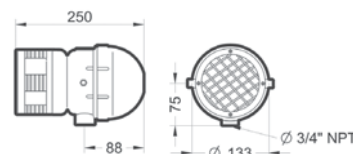

	INERIS 02	ATEX 0001	T6	
V 	12	24	100	240-
A	12	6.3	2	1
dB(A)1m	114	114	114	114
Hz	650	650	650	650



Kg. 3,45



ETS60114DB12DA	62225	ETS60114DB110DA	62227
ETS60114DB24DA	62229	ETS60114DB240DA	62228

V 12/24-110-240 (±10%)		 50/60 Hz	Praca ∞	IP ₆₅
		°C -50 +50	 Ø 3/4" ISO 7/1	

II 2 GD Ex de IIC Ex tD A21
Syreny elektroniczne do stref zagrożonych wybuchem

ETH12 MD



	INERIS 02	ATEX 0074	T6	
V 	12 ÷ 24	-	-	
V 		110	240	
mA	965	45	30	
dB(A)1m	Min. 91 - Max. 109			

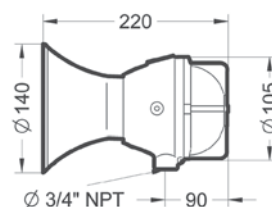



Kg. 1,40

ETH12MD1224DA	57994	ETH12MD240A	57996
ETH12MD110A	57997		

ETH20 MD



	INERIS 02	ATEX 0074	T6	
V 	12 ÷ 24	-	-	
V 			240	
mA	550		25	
dB(A)1m	Min. 101 - Max. 112			

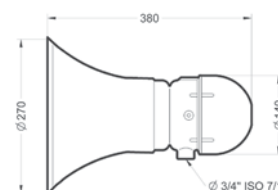

Kg. 3,35

ETH20MD1224DA	57998	ETH20MD240A	57995
---------------	-------	-------------	-------