

1.1.3 SERIA MICROSAI

V ₁₂₋₂₄₋₄₈₋₁₁₀₋₂₃₀₋₂₄₀ (±10%)		~ 50/60 Hz		Praca ∞		M 16	
IP 65						Hz 300÷350	
						°C -30 +40	

Dźwięk ciągły



MICROSAI
MS

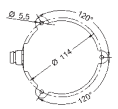
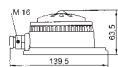

Kg. 0,31

V~	12	24	48	110	240
mA	830	415	210	90	42
dB(A)1m	95	95	95	95	95

MS12A	53002	MS110A	53008
MS24A	53003	MS240A	53015
MS48A	53005		
MSSD12A	53050	MSSD110A	53054
MSSD24A	53051	MSSD240A	53057
MSSD48A	53053		



MICROSAI SD
MS SD

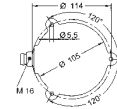
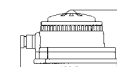

Kg. 0,38

Dźwięk przerywany



MICROSAI SI
MS SI

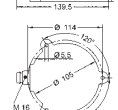
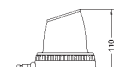

Kg. 0,33

V~	12	24	48	110	240
mA	850	430	220	95	45
dB(A)1m	95	95	95	95	95

MSSI12A	53530	MSSI110A	53533
MSSI24A	53531	MSSI240A	53535
MSSI48A	53532		
MSSDSI12A	53551	MSSDSI110A	53554
MSSDSI24A	53552	MSSDSI240A	53556
MSSDSI48A	53553		



MICROSAI SD SI
MS SD SI

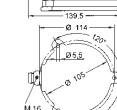
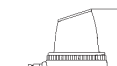

Kg. 0,39

Dźwięk ciągły

MICROSAI R
MSR
Dźwięk ciągły

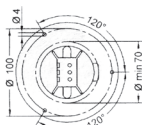
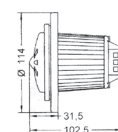

Kg. 0,42

V~	12	24	48	110	240
mA	830	415	210	90	42
dB(A)1m	95	95	95	95	95

MSR12A	53537	MSR110A	53540
MSR24A	53538	MSR240A	53542
MSR48A	53539		
MSSDR12A	53558	MSSDR110A	53561
MSSDR24A	53559	MSSDR240A	53563
MSSDR48A	53560		

MICROSAI SD R
MSSDR
Dźwięk ciągły

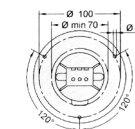
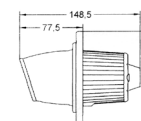

Kg. 0,42

Dźwięk przerywany

MICROSAI R SI
MSRSI
Dźwięk przerywany

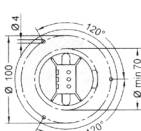
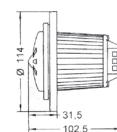

Kg. 0,42

V~	12	24	48	110	240
mA	850	430	220	95	45
dB(A)1m	95	95	95	95	95

MSRSI12A	53544	MSRSI110A	53547
MSRSI24A	53545	MSRSI240A	53549
MSRSI48A	53546		
MSSDRSI12A	53565	MSSDRSI110A	53561
MSSDRSI24A	53566	MSSDRSI240A	53563
MSSDRSI48A	53567		

MICROSAI SD R SI
MSSDRSI
Dźwięk przerywany

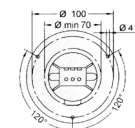
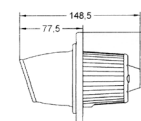

Kg. 0,42